



ELECTRONIC THERMOSTATS 1- AND 2-STAGE

DB-I1D, -I2D

FUNCTION

Temperature control in heating or cooling systems with:

- 1 or 2 relay outputs (depending on models);
- 2 different working ranges;

- 1 input for NTC 10K sensor (not included) and 1 input for remote setpoint controller (not included).

TYPE	STAGES	RANGE °C	DIFF. IN THE STAGE K	DIFF. BETW THE STAGES K	MAX TEMP. SENSOR °C
DB-I1D/1	1	-10...+40	+0.5...+6		-40...+110
DB-I1D/2	1	+30...+80	+0.5...+6		-40...+110
DB-I2D/1	2	-10...+40	+0.5...+6	+0.5...+6	-40...+110
DB-I2D/2	2	+30...+80	+0.5...+6	+0.5...+6	-40...+110

On request:

remote setpoint control; code: DB-CDP/N1

TECHNICAL DATA

Power supply:	230 Vac \pm 10%, 50/60 Hz
Input:	for 1 NTC 10K sensor remote setpoint controller (optional)
Output:	1 or 2 relays SPDT 10 A 230 Vac
Power cons.:	< 1.5 W
Precision:	\pm 1 °C
Working:	-20...+50 °C 10...90% r.h. (without condensing)
Storage:	-20...+70 °C < 95% r.h.
Housing:	ABS fireproof according to UL94 V-0
Protection:	IP65, class II
Size:	132 x 85 x 88 mm
Weight:	480 g

DB-I2D

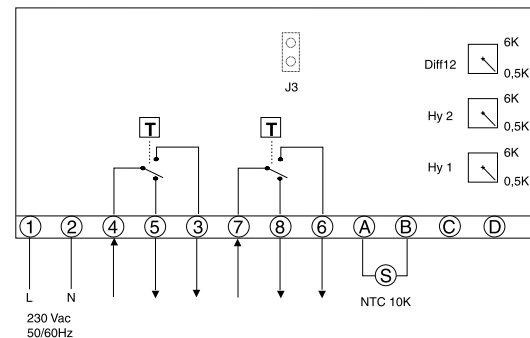

Jumper setting:

- J3 closed = cooling
- J3 open = heating

The products are factory supplied with cooling jumper setting.
The regulator is able to recognize automatically if the remote setpoint controller is connected to the unit.

WIRING DIAGRAM

Terminal connections for heating or cooling systems with 1 or 2 stages.

DB-I1D

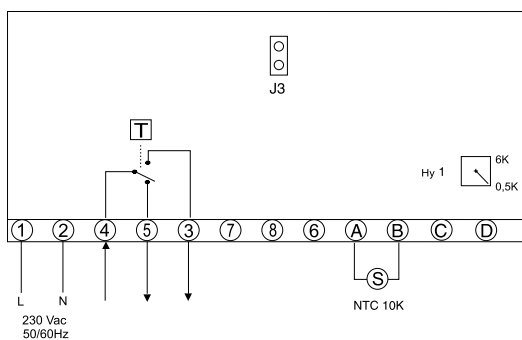

Connections between DB-IXD and DB-CDP/N1.

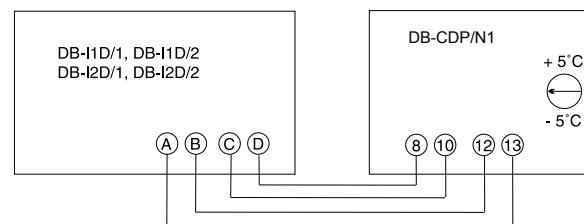

ELECTRONIC THERMOSTATS 1- AND 2-STAGE

DB-I1D, -I2D

DIMENSIONS (mm)

DB-I1D

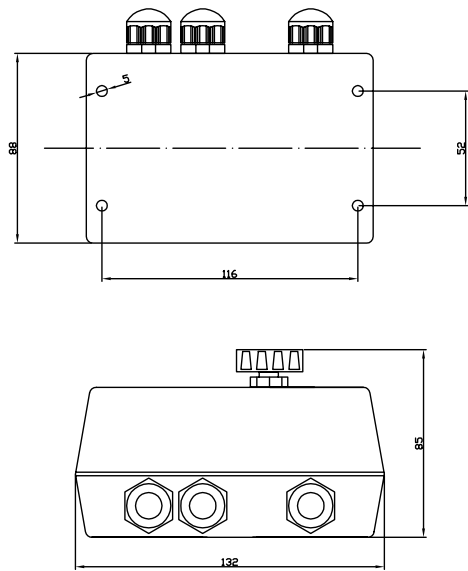

DB-I2D

